

# BEECHGROVE ELEMENTARY 1029 Bristow Rd

Park in the lower lot of the school  
Enter the double doors of the gym  
Voting is in the gym







# CALVARY STUDENT LIFE CENTER 3708 Tibbatts Street

Student Life Center is across the street from the Calvary Baptist Church. Enter the parking lot off W. 38<sup>th</sup> Street. The double doors to the gym face W. 38<sup>th</sup> Street.

Voting in the Life Center's gym





# COVINGTON LIBRARY

502 Scott Blvd.

Enter main entrance.

There are steps and an elevator to the second floor

Voting area is in the 2<sup>nd</sup> Floor conference room behind the circulation desk

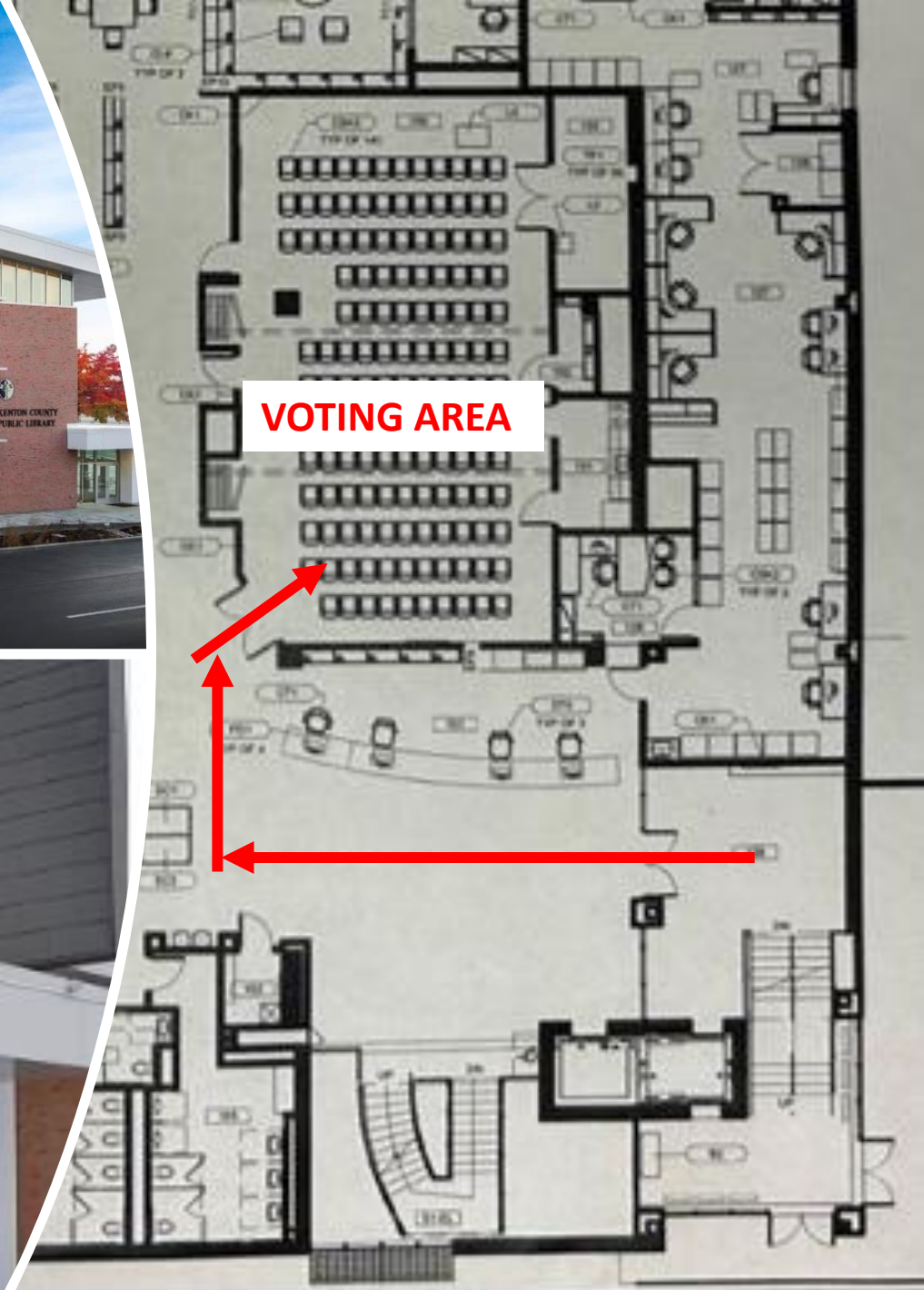





# CRESCENT SPRINGS CITY BUILDING 739 Buttermilk Pike

Enter Main doors

Voting is in Council  
Chambers

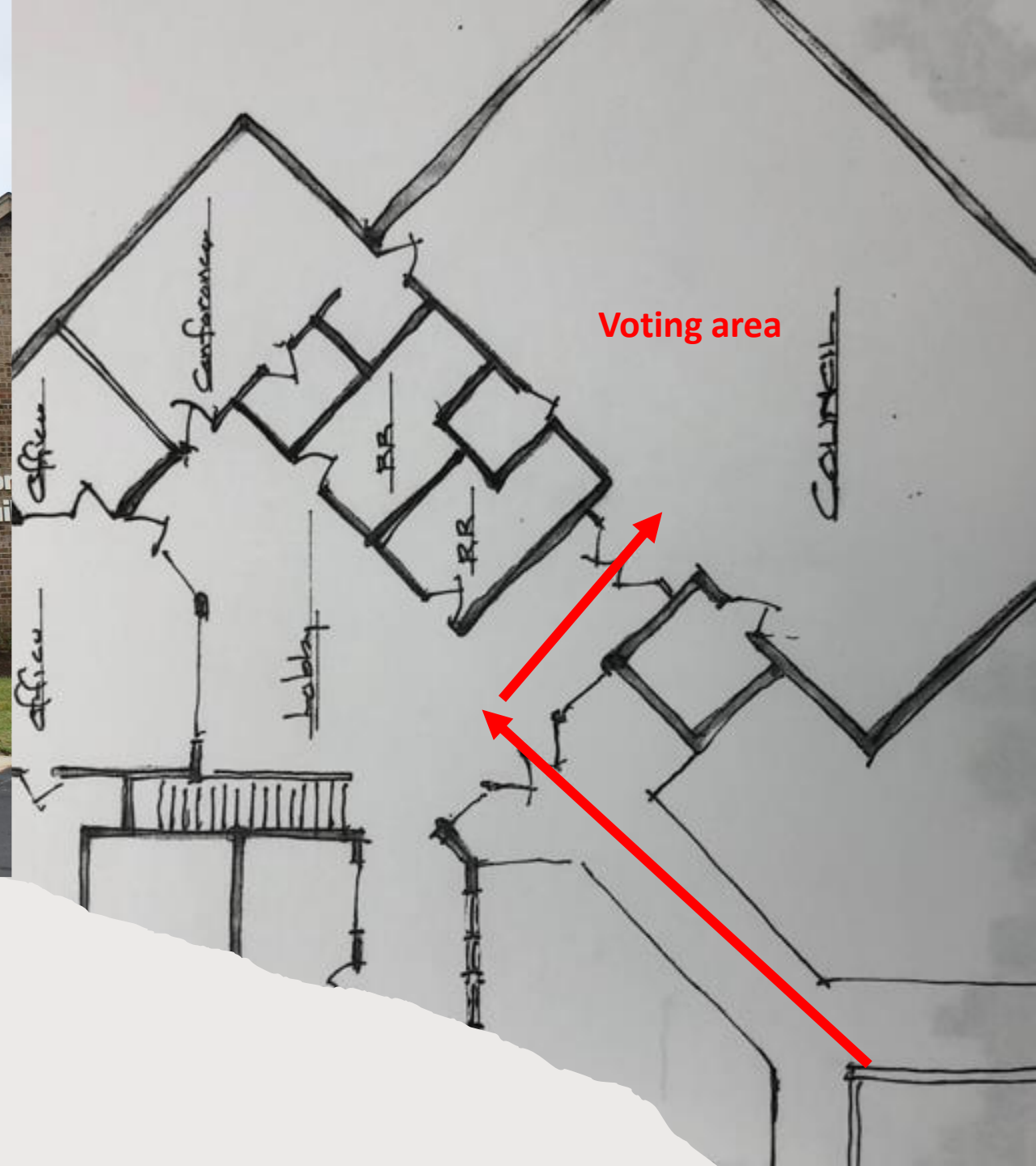



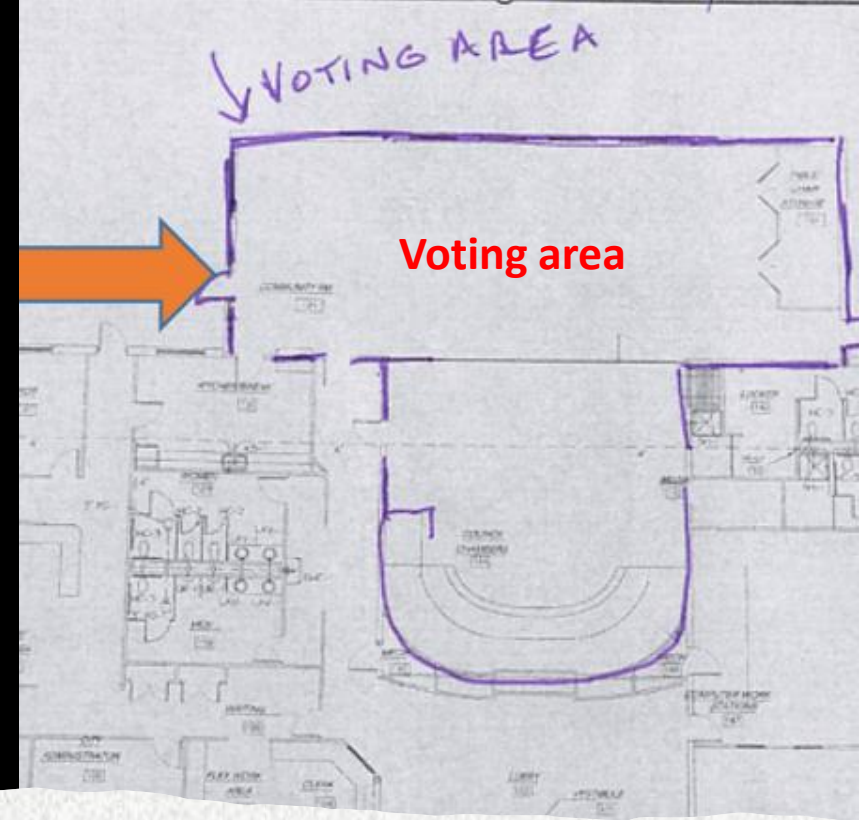

# CRESTVIEW HILLS ADMIN BUILDING

## 50 Town Center Blvd

Enter through the back of building

Voting is in Council Chambers





Side door



Main entrance

# DEVOU GOLF & EVENT CENTER

## 1201 Park Dr

Enter by side door or front door

Voting is in Reception Hall

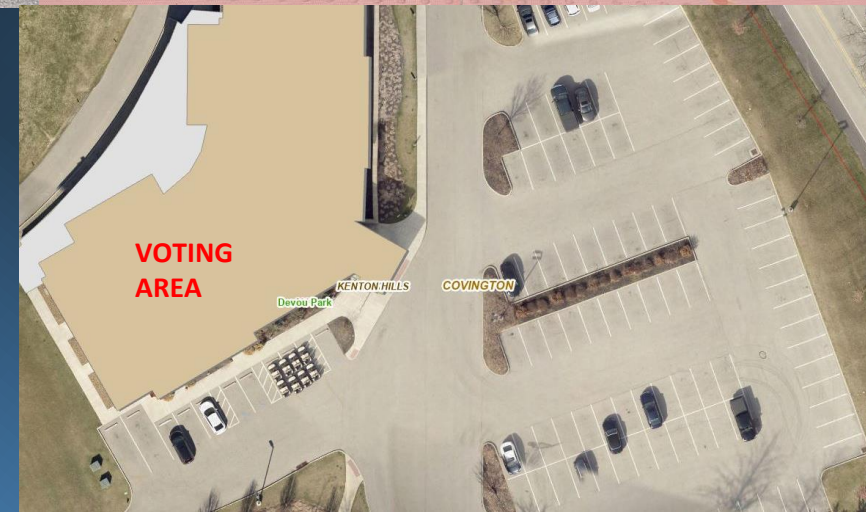





# EDGEWOOD LIBERTY HALL

## 550 Freedom Park Drive

Enter through front double doors

Voting is in main hall

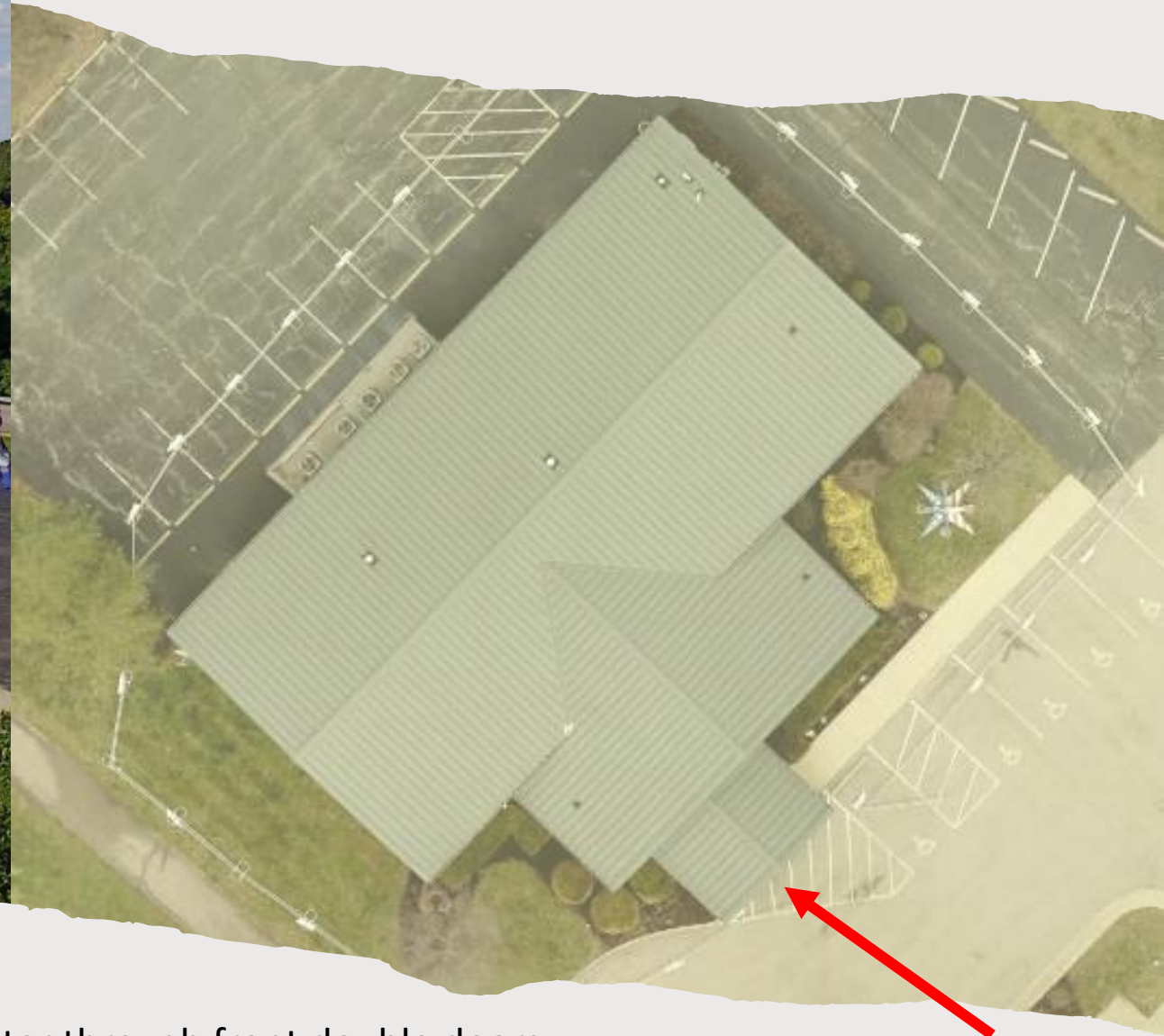



# ELSMERE CITY BUILDING 3921 Dixie Hwy

Enter main doors

Voting area is down the  
hallway in the Council  
Chambers

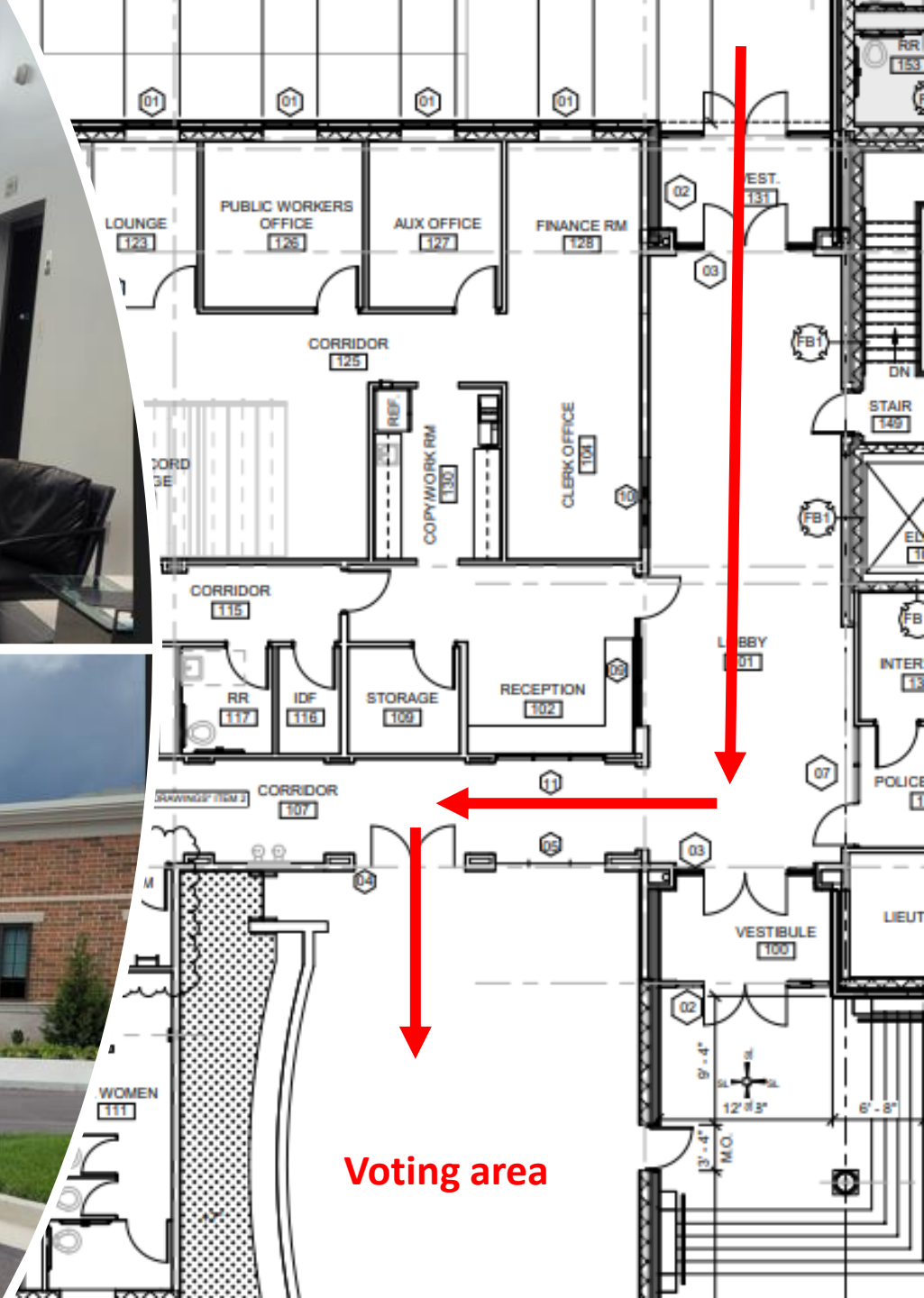



# ELSMERE COMMUNITY CENTER

## 179 Dell Ave

Entrance is door on back of building on the lower level

Voting is in the Lower Level activity room

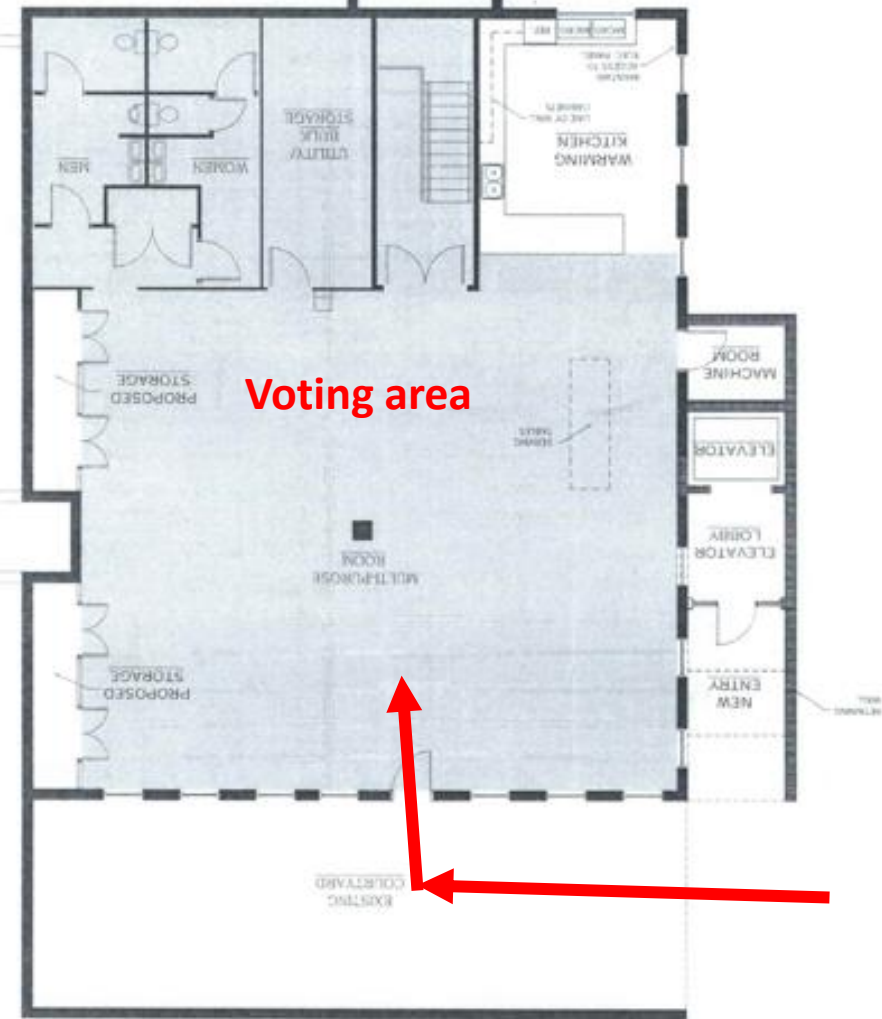





EMERALD SPRINGS  
CLUBHOUSE  
2201 Edenderry Dr

Enter through main door

Voting is in the main area of the clubhouse



# ERLANGER LIBRARY 401 Kenton Lands Rd

Enter the front doors of the library

Voting is the first room on the left  
called Meeting room A and  
Meeting room B

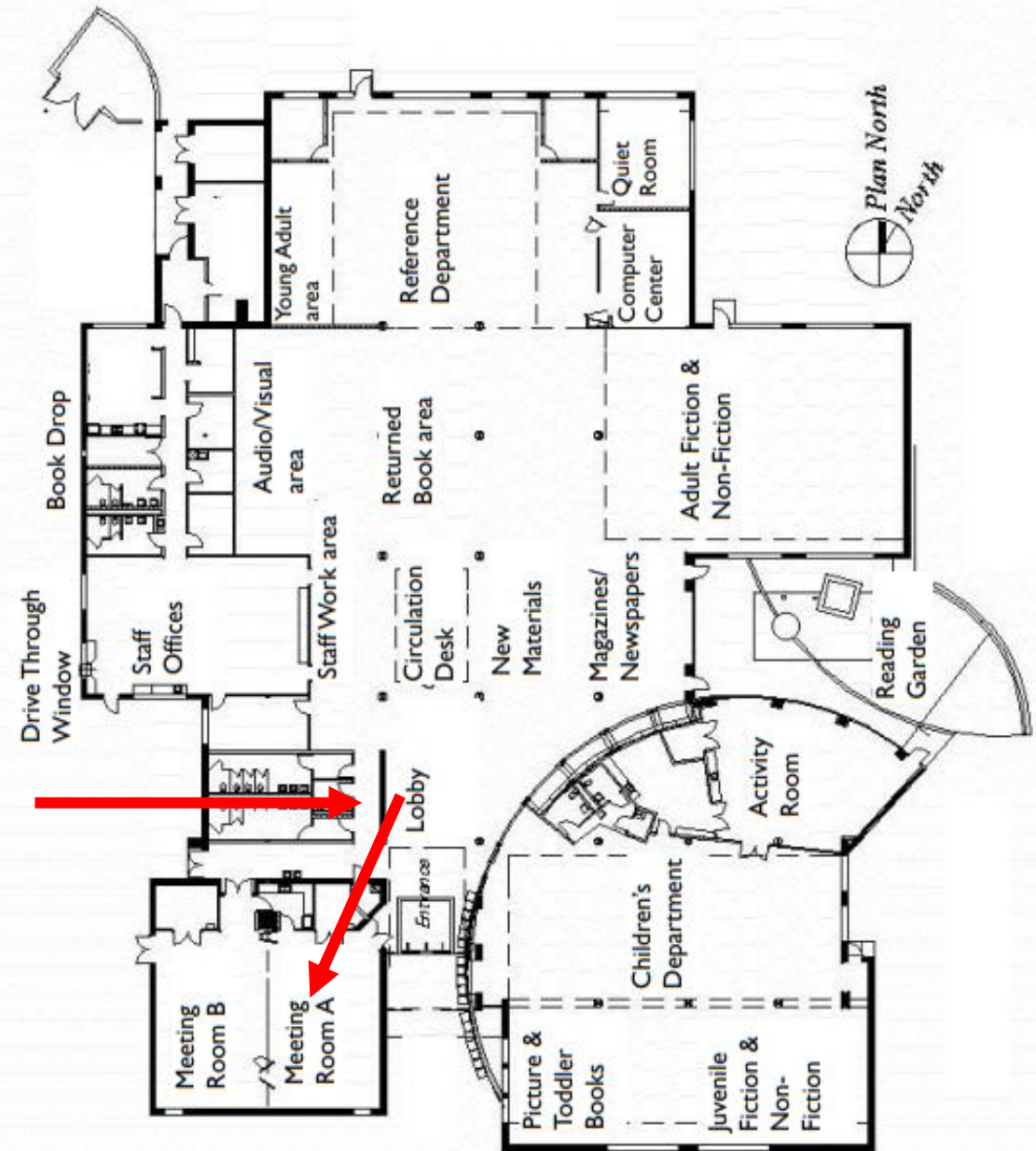



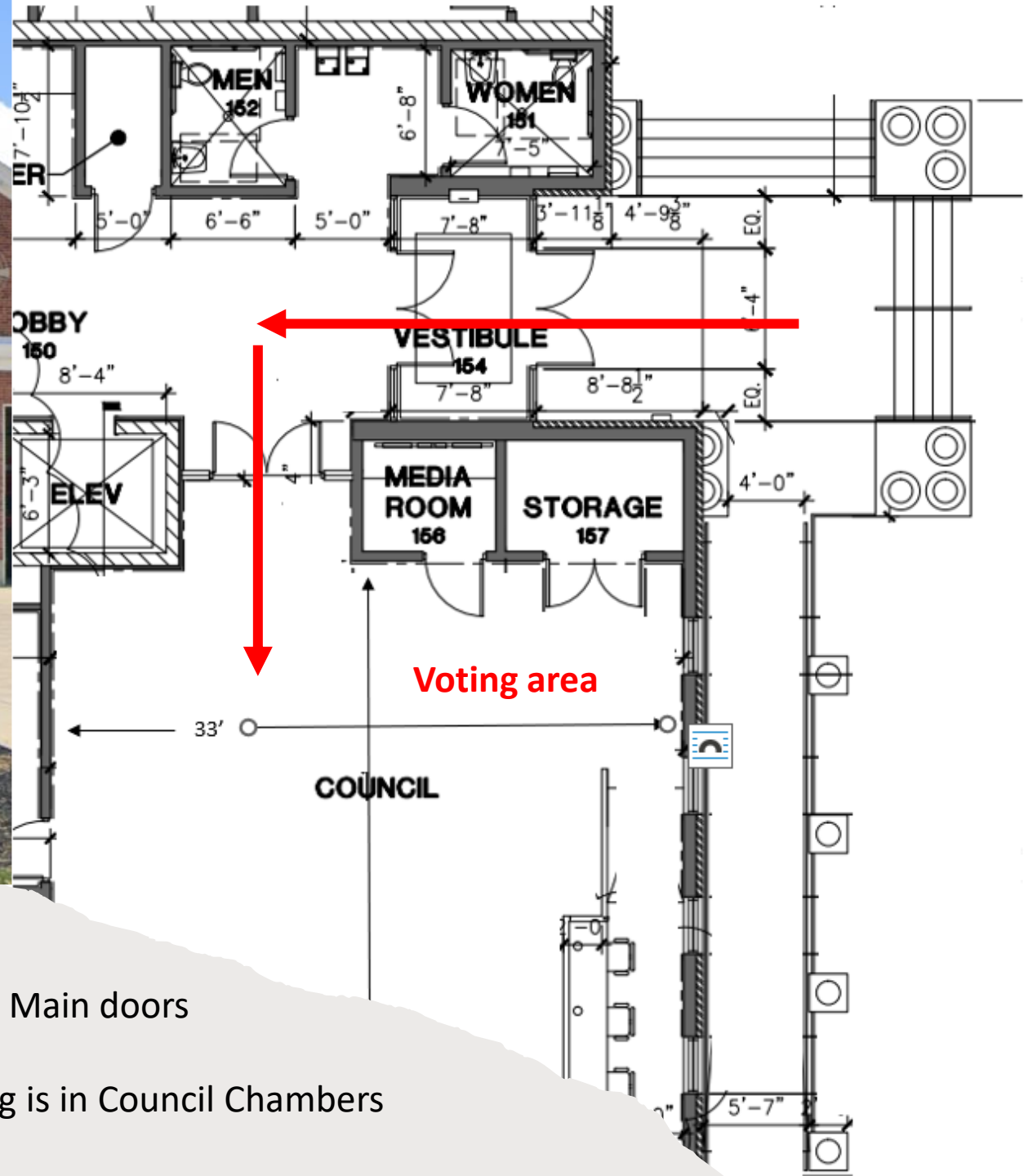

## Voting is in Council Chambers



# FT WRIGHT CIVIC CLUB

## 115 Kennedy Rd



Enter main double doors

Voting is main hall of Civic Club





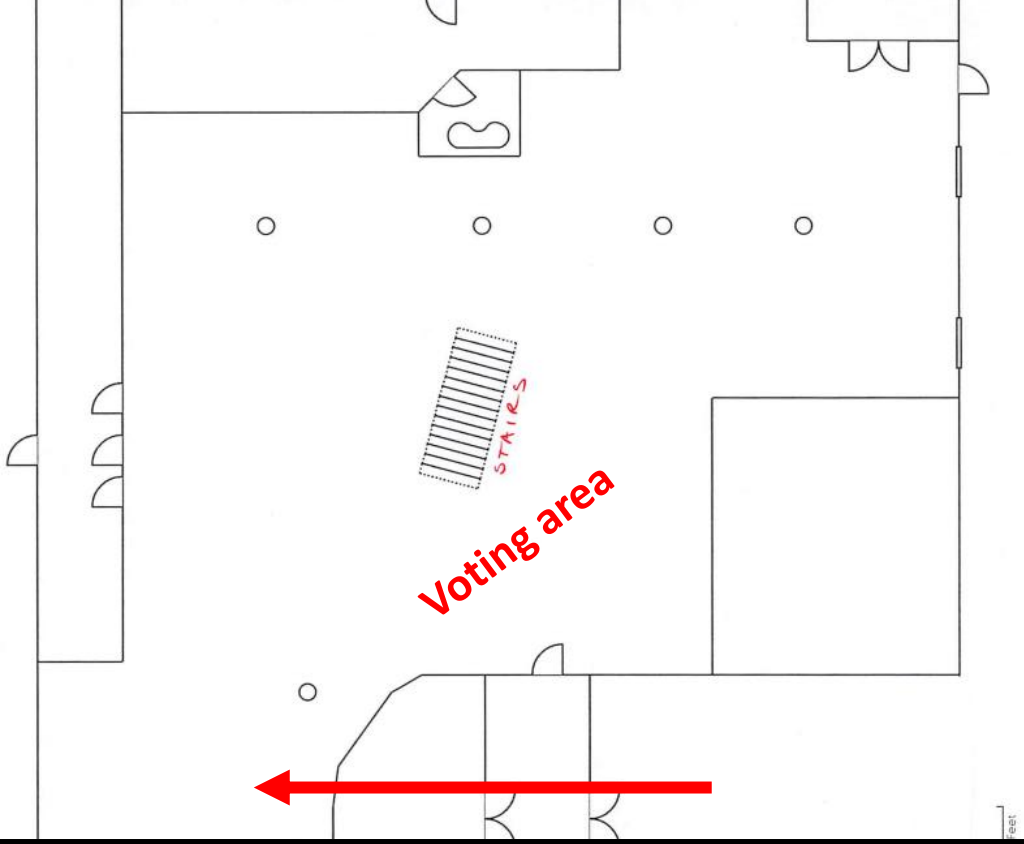

## GARDENS OF PARK HILLS

### 1622 Dixie Highway

Enter through the Upper Level double doors

Voting is in the event area right inside the doors



# GLENN O SWING ELEMENTARY

501 W. 19<sup>th</sup> St.

Parking lot entrance is off  
Chapman Street

Enter through front door

Voting is in the school gym

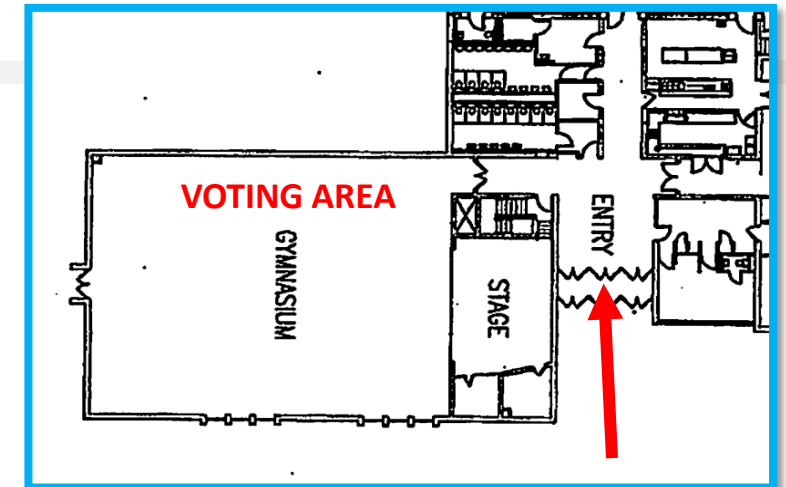



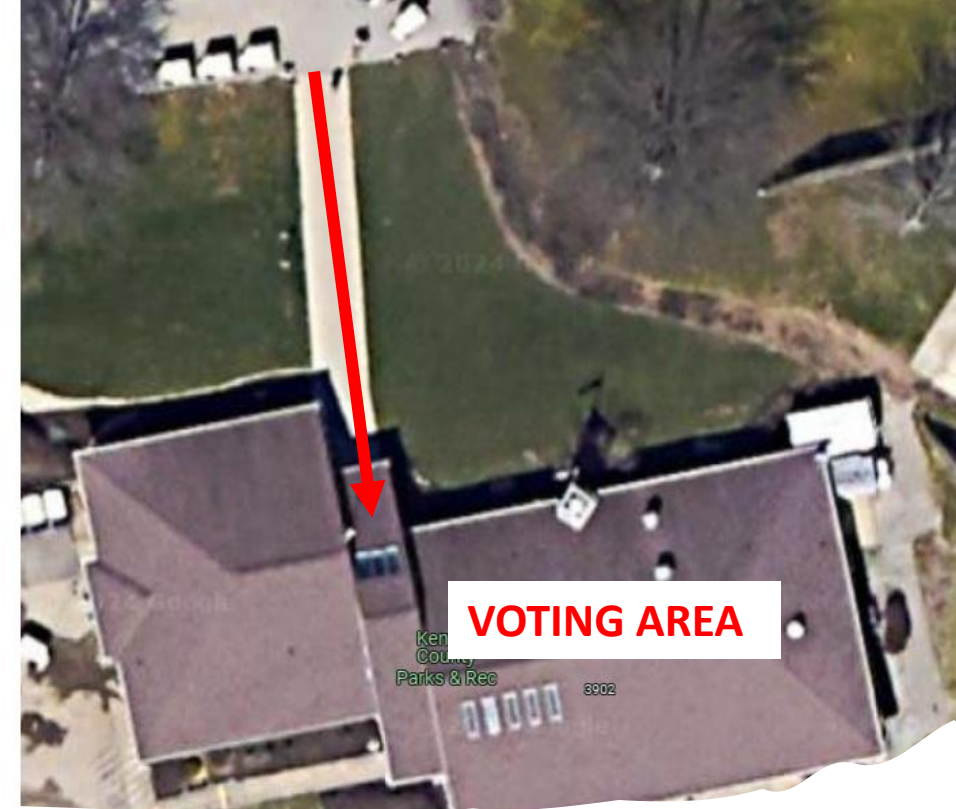

# GOLF COURSES OF KENTON COUNTY 3908 Richardson Rd

Enter through main doors

Voting is in the banquet room



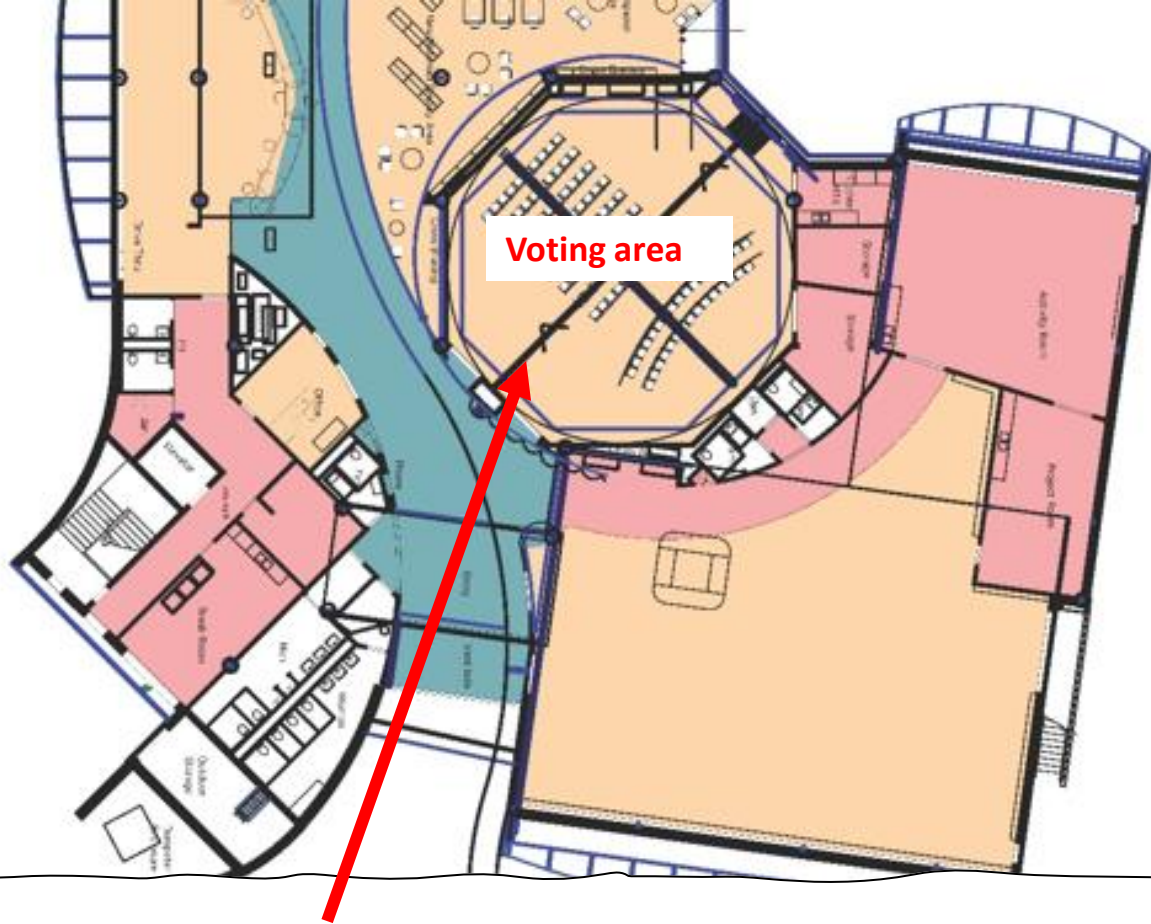

INDEPENDENCE LIBRARY  
1992 Walton Nicholson Rd

Main entrance and parking in the back of the building  
Enter through the main doors  
Voting is in the large circular meeting room to the right



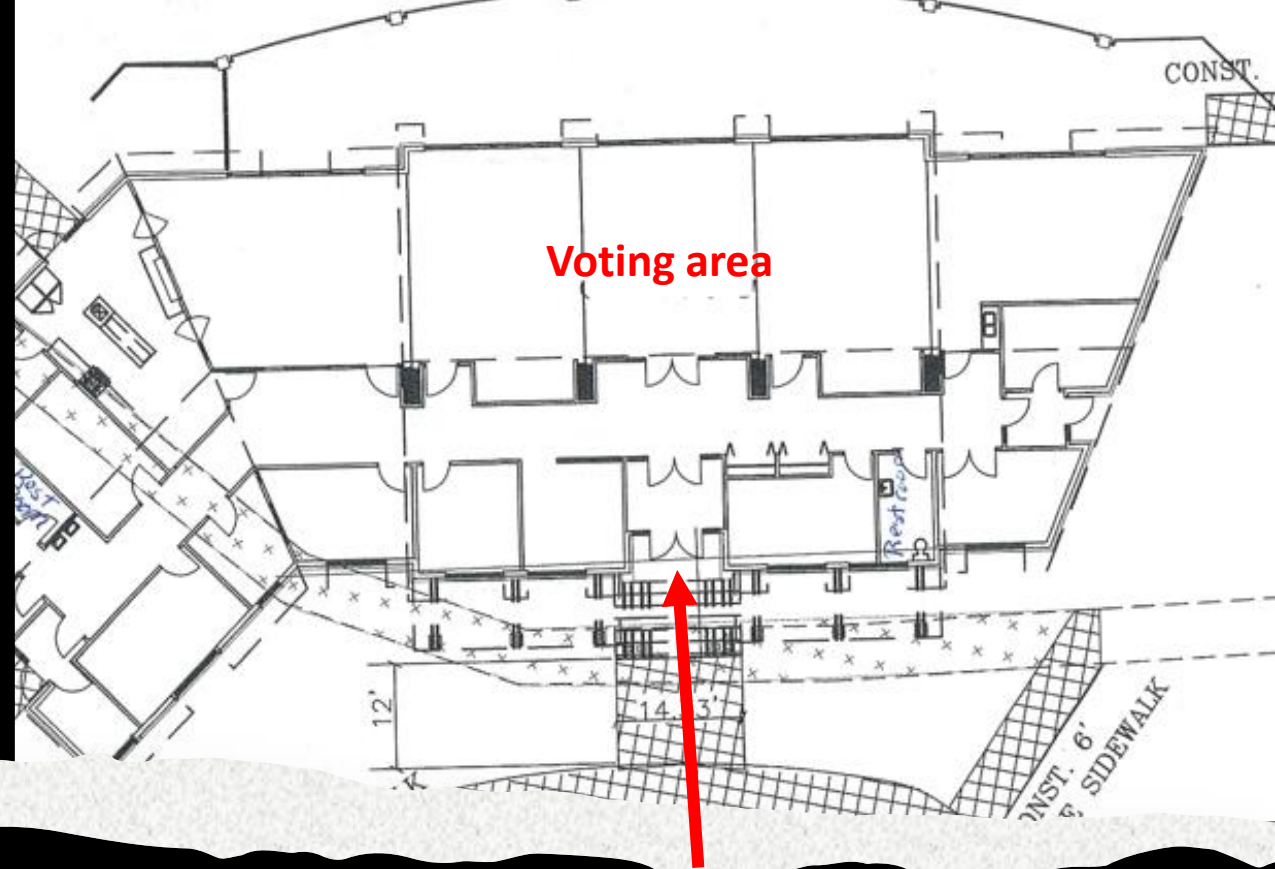

# INDEPENDENCE SENIOR CENTER

## 2001 Jackwoods Pkwy

Enter through front double doors

Voting is the activity room at the back of the building



**JOHN G CARLISLE  
ELEMENTARY  
910 Holman Ave**

Enter the side entrance on  
Banklick Street which is for  
student drop off.

Voting is in the school gym







# KENTON COUNTY GOV'T CENTER

1840 Simon Kenton Way

---

Enter through main front doors.

Take either elevator or steps to 2<sup>nd</sup> Floor.

Voting is in the Riedlin Schott Room



Riedlin Schott Room-  
Voting area



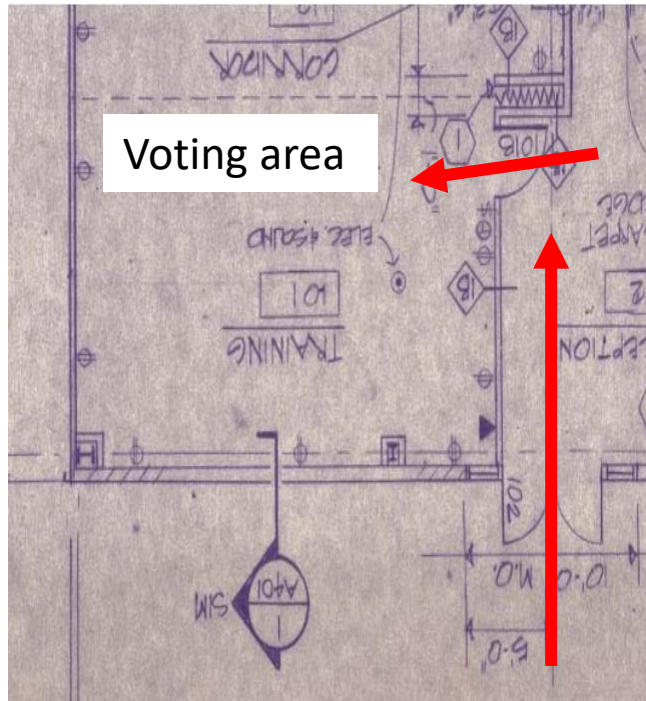

# KENTON COUNTY PUBLIC WORKS 420 Independence Station Rd

Enter front doors

Voting area is in the conference room to the left.





# LAKE SIDE CHRISTIAN CHURCH

195 Buttermilk Pike

Parking in back of building.

Enter through the doors at the far right of the building

Voting is in the Student Center

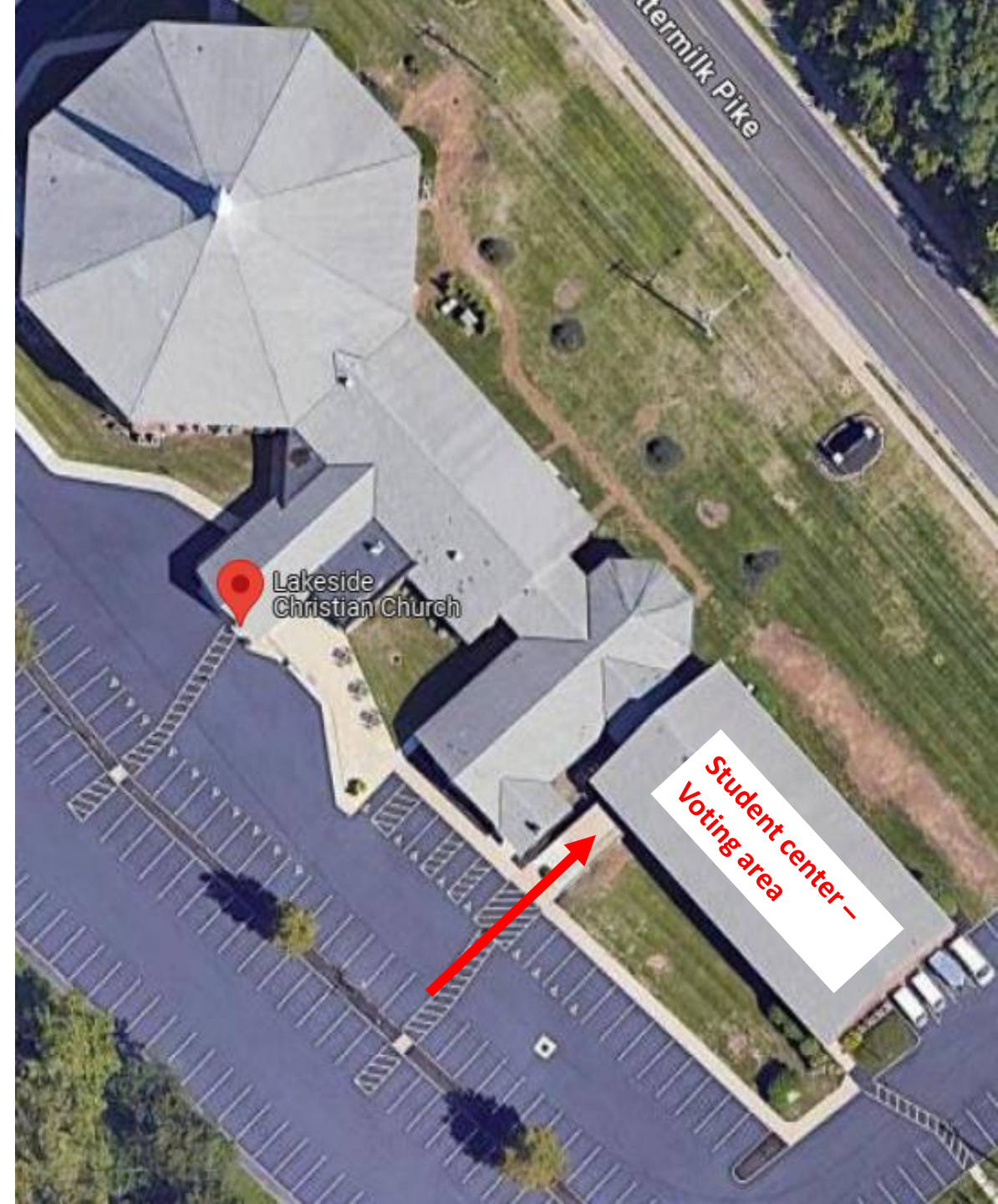





# LATONIA ELEMENTARY

## 3901 Huntington Ave

Enter the gym door on the side of the school

Voting is in the school gym



# LOOKOUT HEIGHTS CIVIC CLUB 1661 Park Rd

Enter through the double door  
marked President's Hall.

Voting is in the main hall of the  
Civic Club







808

**RAMP**

# LUDLOW COMMUNITY CENTER

## 808 Elm St

There is a ramp that leads to the front door

Enter main doors at top of ramp

Voting in center's activity room





**MADISON AVENUE CHRISTIAN CHURCH**  
**1530 Madison Avenue**

Enter through the side door off the parking lot.

Voting is in the Community room



MOORE ACTIVITY CENTER  
304 Linden Avenue

Entrance faces Linden Avenue and is at the top of the ramp.

Additional parking is off Holman Street at the other end of the Southside Baptist Church

Voting is in the activity room

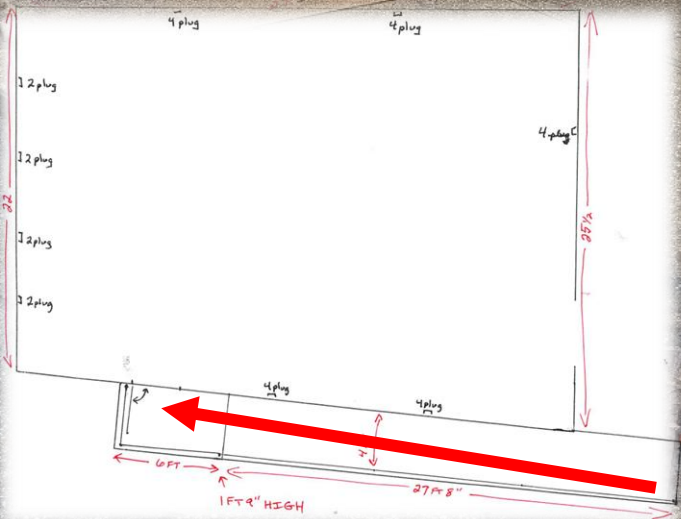
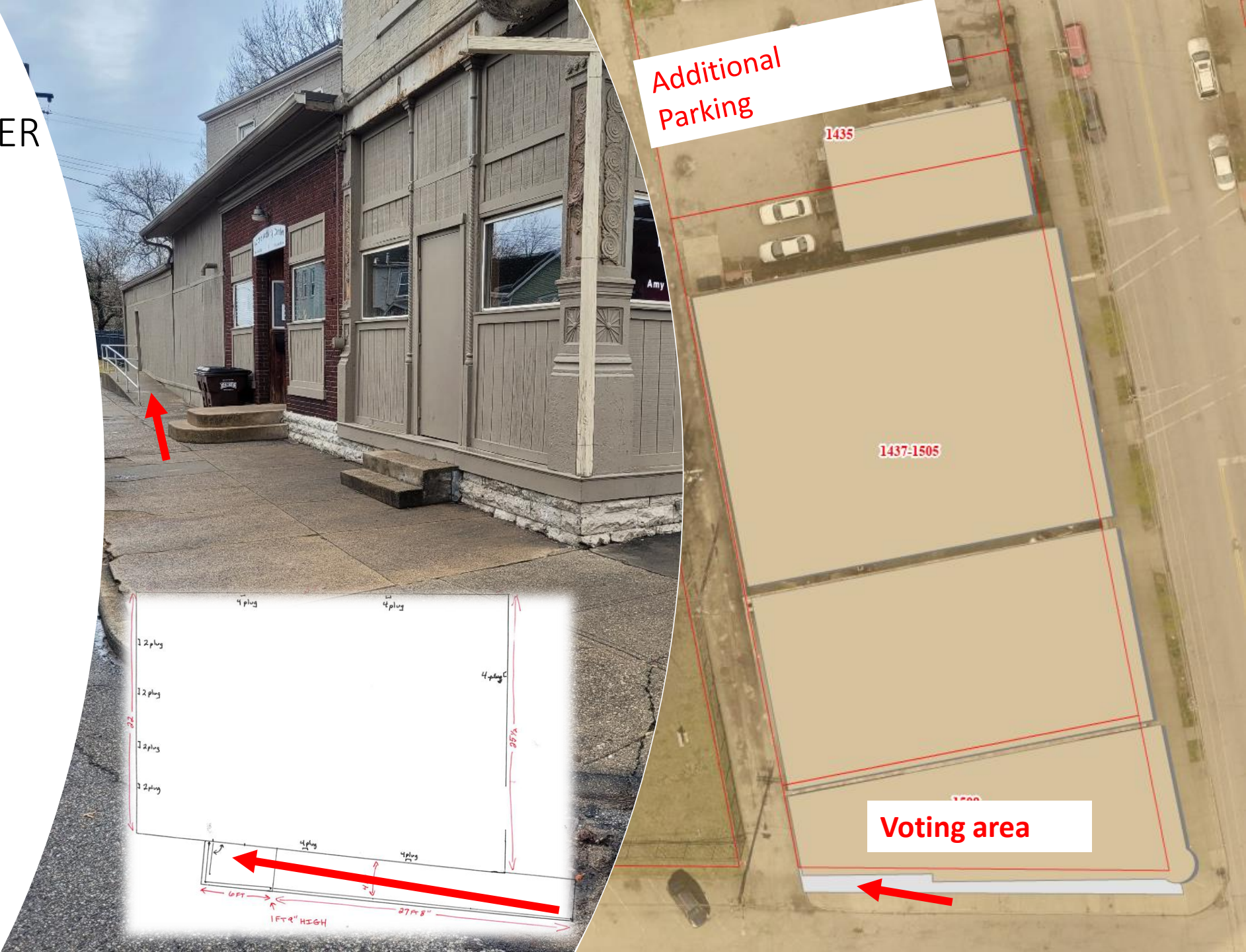



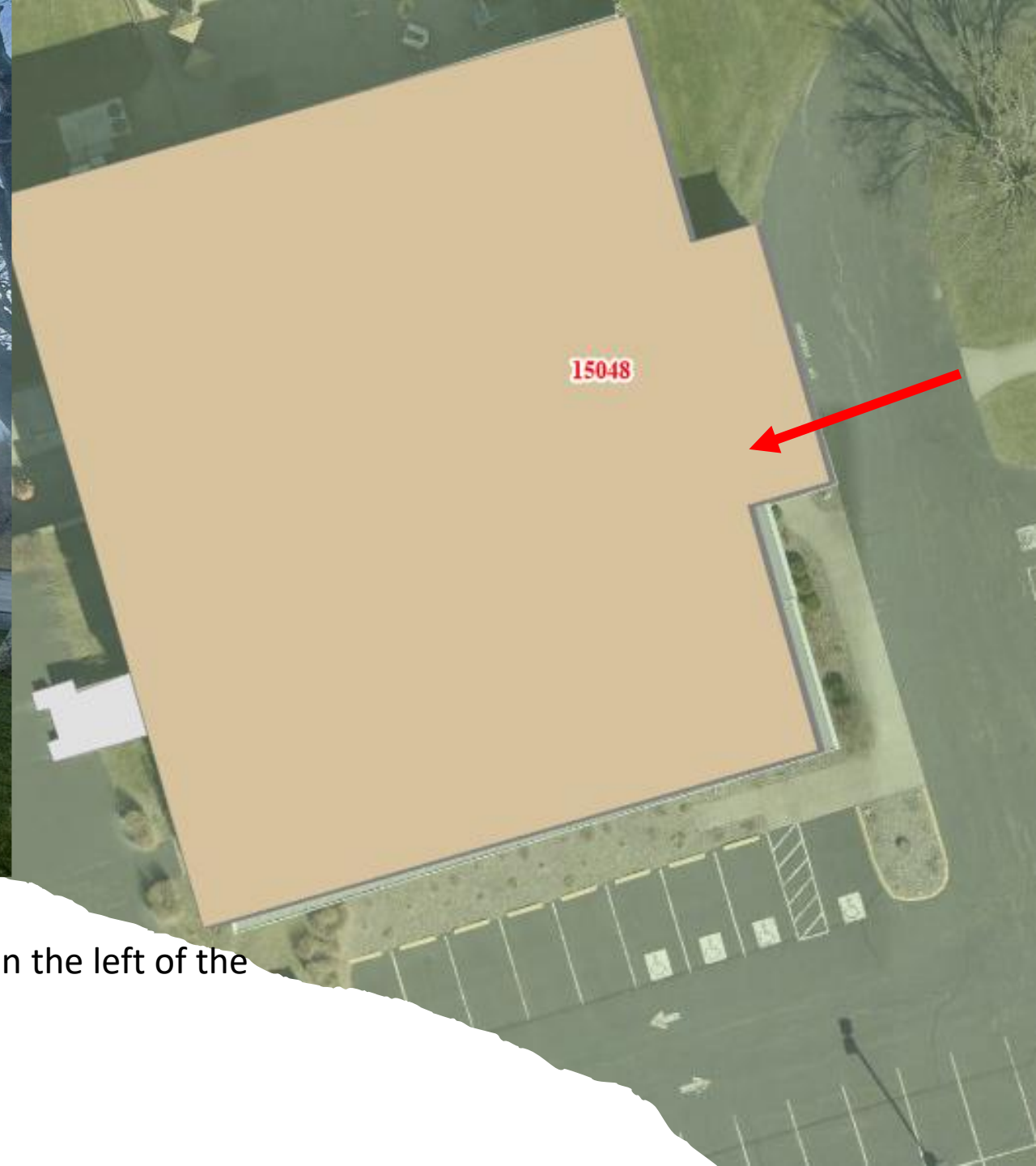

PINER BAPTIST CHURCH  
15044 Madison Pike

Enter through double doors on the left of the  
main entrance

Voting area in the foyer



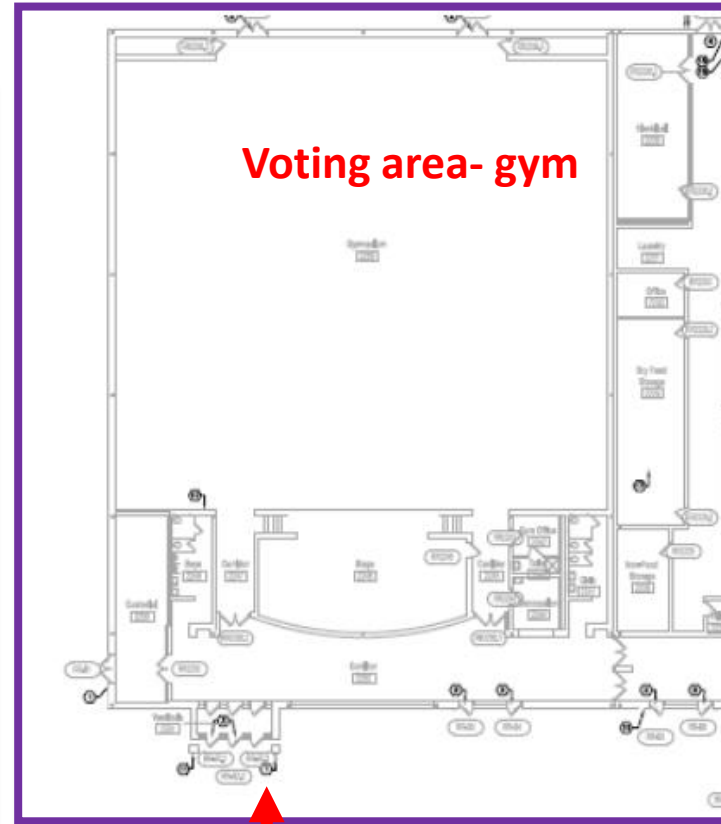

## RIVER RIDGE ELEMENTARY

2772 Amsterdam Road

Entrance is to the far left of the school

Voting area is in the school gym



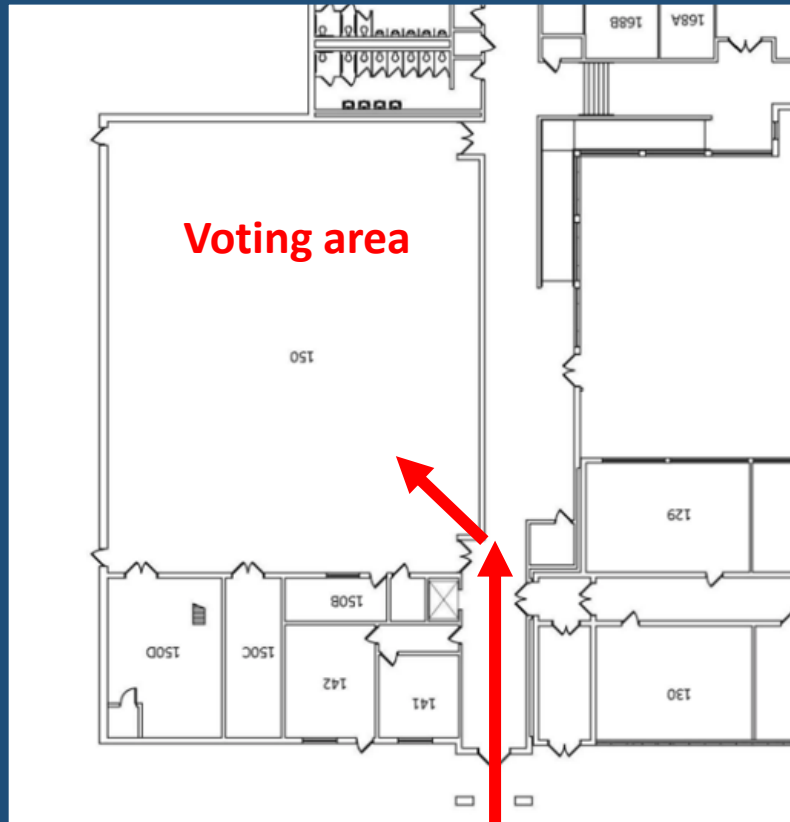

Enter double doors on left of building

Voting in school gym



**RYLAND HEIGHTS  
ELEMENTARY SCHOOL  
3845 Stewart Drive**



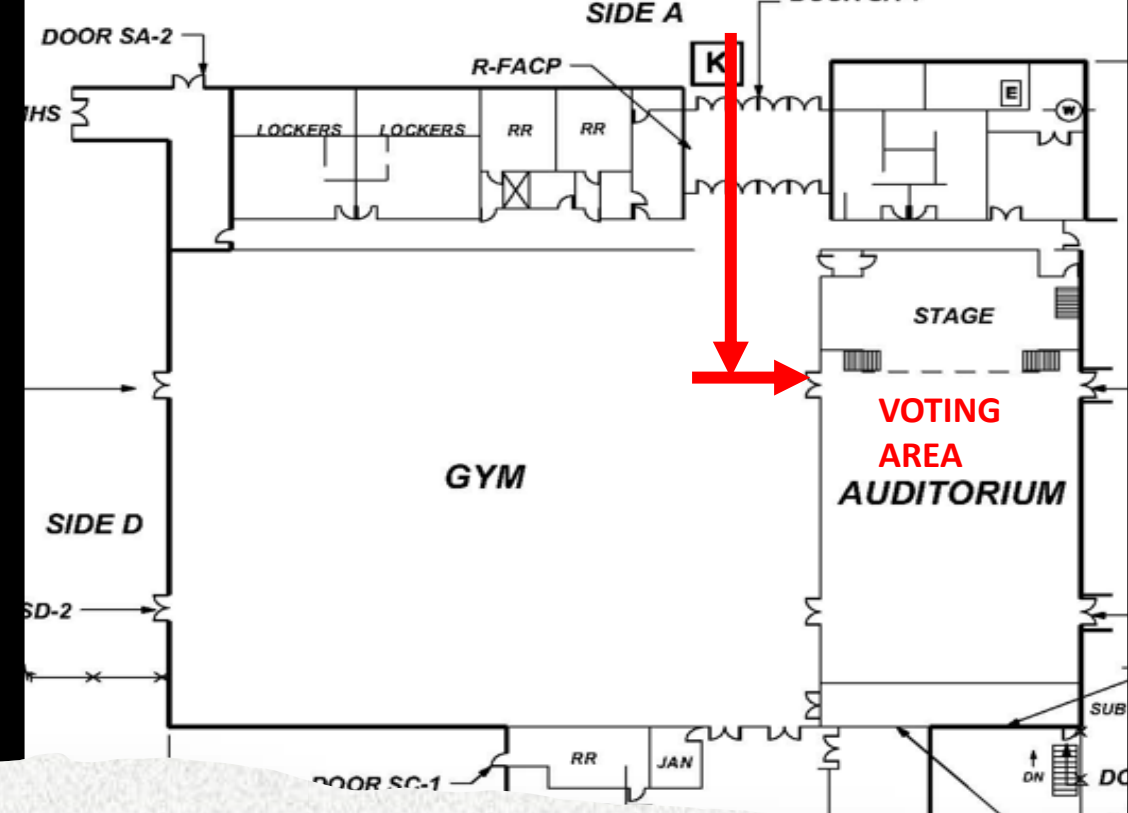

SCHEBEN GYM  
450 Bartlett Ave

Enter Scheben Gym/ Dietz Auditorium doors  
Voting is in Dietz Auditorium which is inside  
the gym



Enter main doors

Voting is in the Community  
room to the left



**SCHOOL HOUSE BEES**  
**4041 Visalia Rd**







# ST. BARBARA'S CHURCH RECEPTION HALL 4042 Turkeyfoot Rd

Enter at the Sterling Event Center

Voting is in the event center's hall





# SUMMIT VIEW ACADEMY

5006 Madison Pike



Enter through double doors to the left of the main entrance

Voting is in the cafeteria



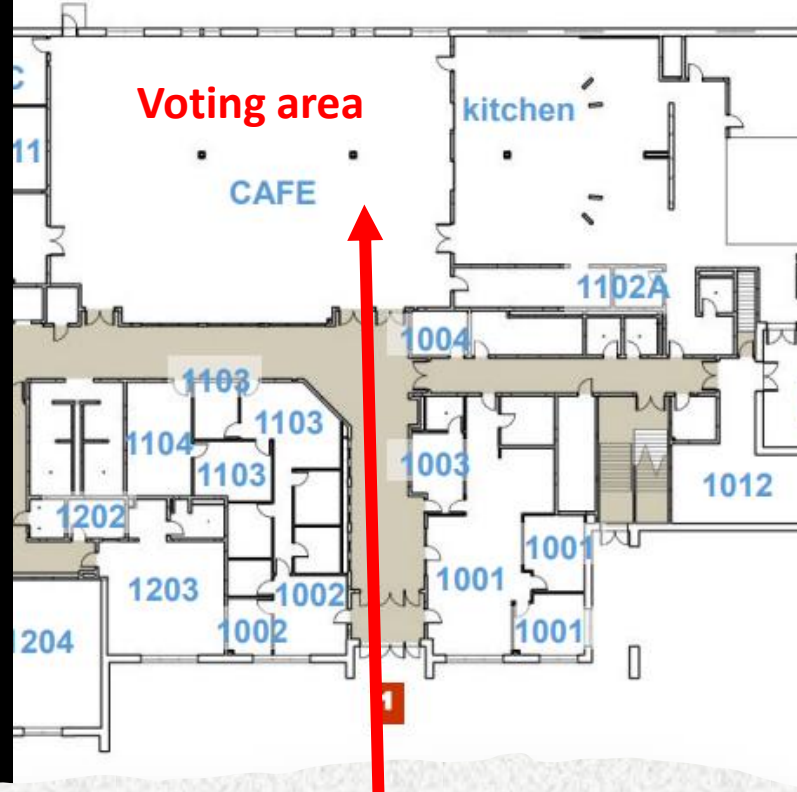

# TURKEYFOOT MIDDLE SCHOOL

## 3230 Turkeyfoot Rd

Due to ADA recommendations, the voting area at Turkeyfoot Middle has been moved from the gym to the school cafeteria.

Enter in the front door of the school

Voting is in the cafeteria



# TAYLOR MILL ELEMENTARY

5907 Taylor Mill Road

Enter the front doors of the school

Voting is in the school gym

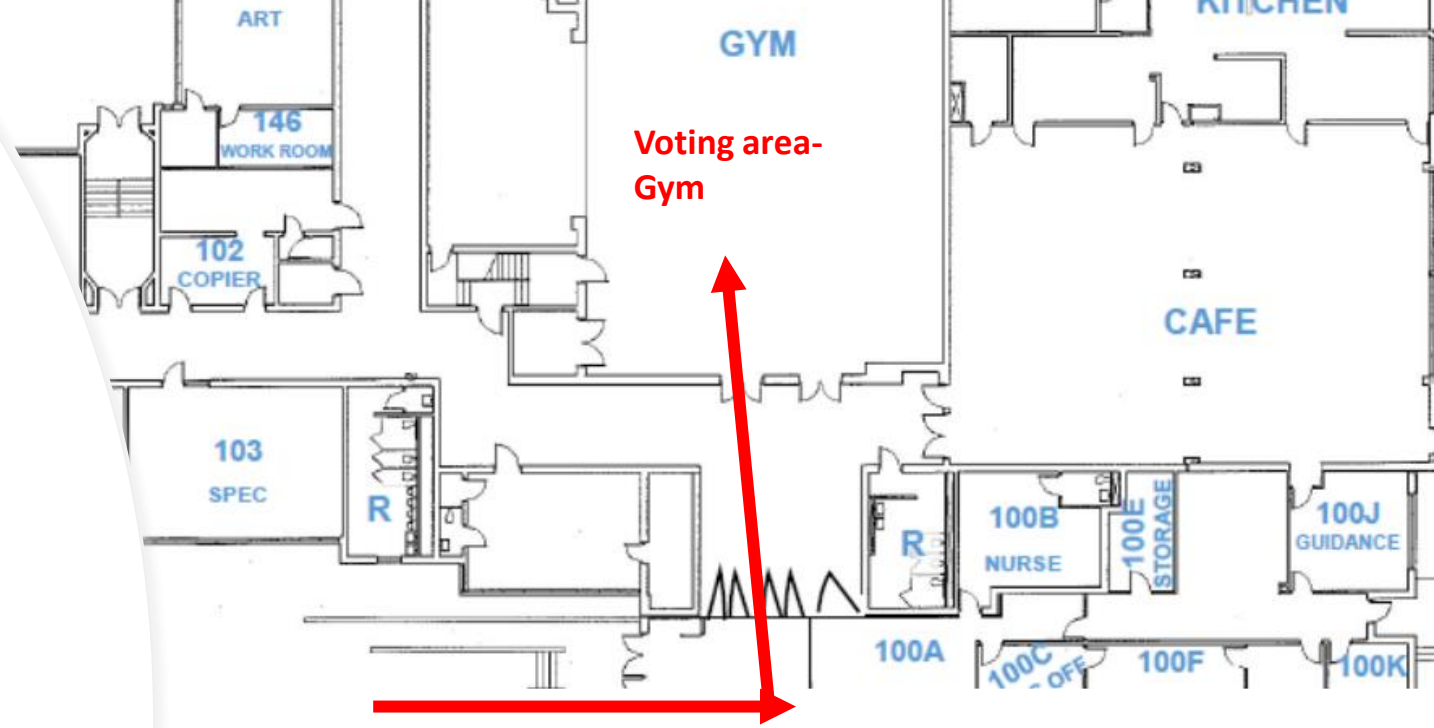



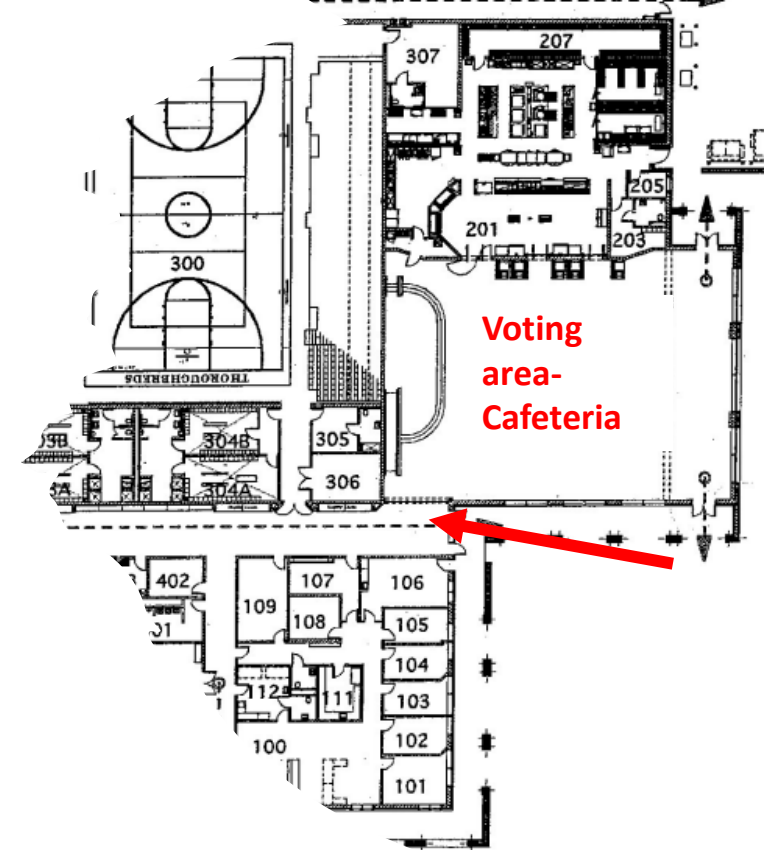
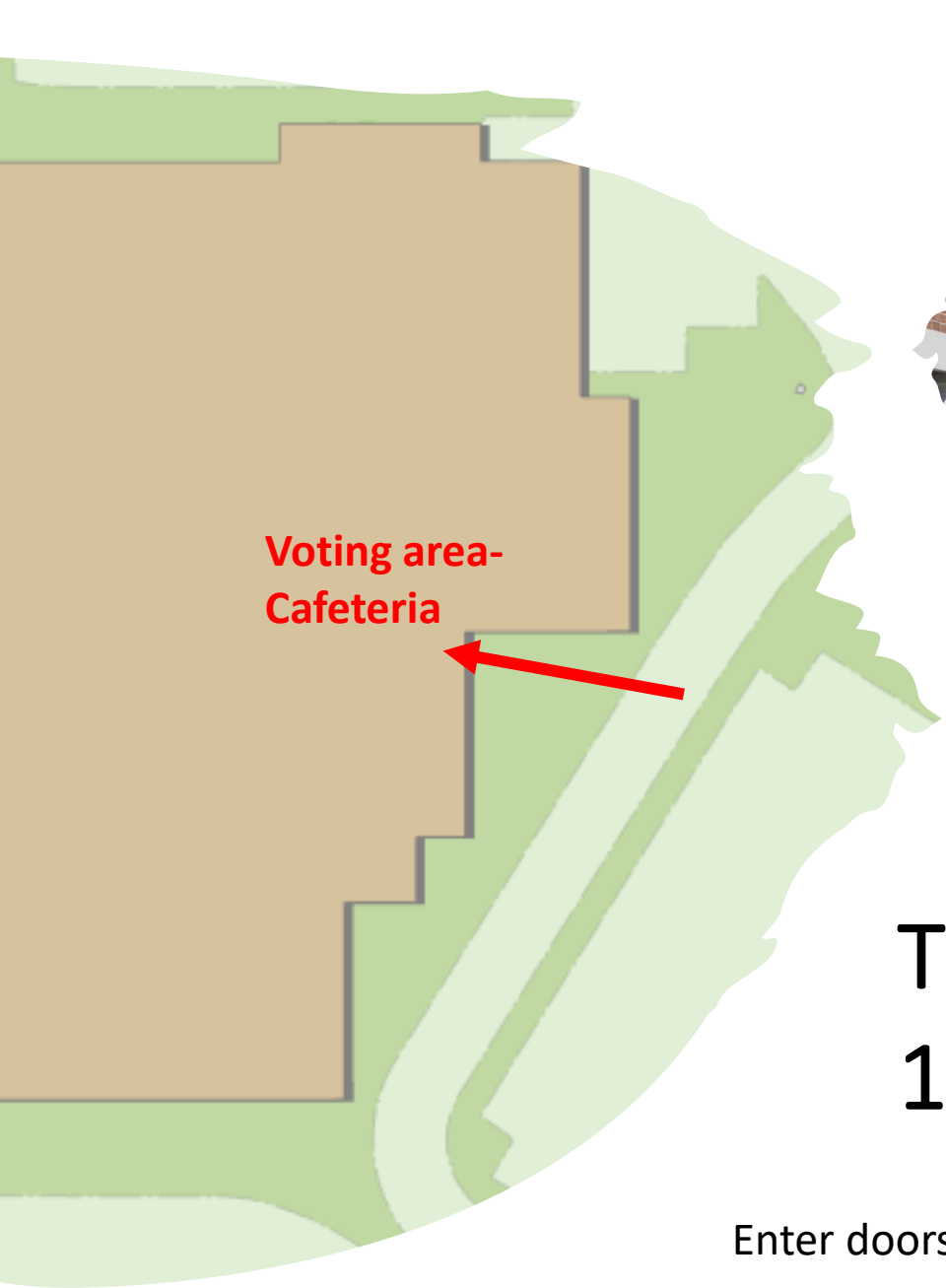

# TWENHOFEL MIDDLE SCHOOL

## 11846 Taylor Mill Road

Enter doors located to the far right of the school entrance

Voting is in cafeteria right inside the doors